

HLS-600 Brass Ball Valve - PN25

Product Features

- Ball Valves are light, compact units which are easy to install and operate, yet their robust construction ensures long, trouble free service life.



Pressure/Temperature Ratings

TEMPERATURE (°C)	-10 to 100	170
PRESSURE (BAR)	25	10

Interpolation shall be used to calculate intermidate pressure rating.

Materials

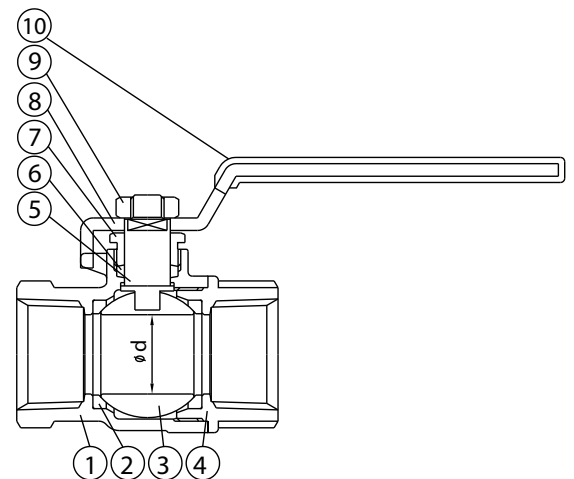
NO.	PART	MATERIAL
1	Body	Brass CW614N
2	Seat Retainer	Brass CW614N
3	Ball	Brass CW614N
4	Seat	PTFE
5	Stem	Brass CW614N
6	Packing	PTFE
7	Gland Nut	Brass CW614N
8	Lever	Mild Steel Chrome Plated
9	Lever Nut	Stainless Steel
10	Lever Cover	PVC

Dimensions

SIZE (inch)	L(mm)	H(m)	D(m)	ø (mm)
1/2	49	37	100	14
3/4	59	40	100	19
1	64	46	110	23
1 1/4	75	57	140	31
1 1/2	85	62	140	38
2	99	71	164	45
2 1/2	121	93	225	57

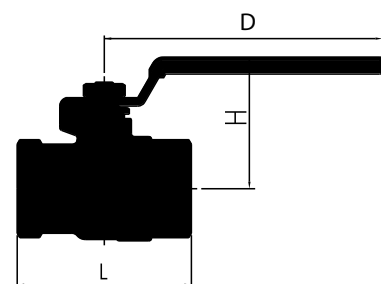

PRESSURE RATING : PN25

TEMPERATURE OPERATING RANGE : -10 to 170°C

END CONNECTION : Taper threaded to ISO 228