

HLZ-600 Bronze Ball Valve - PN25

Product Features

- Ball Valves are light, compact units which are easy to install and operate, yet their robust construction ensures long, trouble free service life.
- HLZ-600 is WRAS approved for use on hot and cold water systems up to 85°C.
- Extension stem to enable valve operation whilst the valve and associated pipework is surrounded with insulation or if the valve is in a hard to access area.
- Conforms to BS EN 13547



Pressure/Temperature Ratings

TEMPERATURE (°C)	-10 to 100	170
PRESSURE (BAR)	25	10

Interpolation shall be used to calculate intermidate pressure rating.

Materials

NO.	PART	MATERIAL
1	Body	Bronze to BS EN 1982 CC491K
2	Seat Retainer	Bronze to BS EN 1982 CC491K
3	Ball	Brass BS EN 12164 CW614N
4	Seat	PTFE
5	Stem	DZR Brass BS EN 12164 CW602N
6	Packing	PTFE
7	Gland Nut	Brass BS EN 12164 CW614N
8	Lever	Mild Steel Chrome Plated
9	Lever Nut	Stainless Steel
10	Lever Cover	PVC

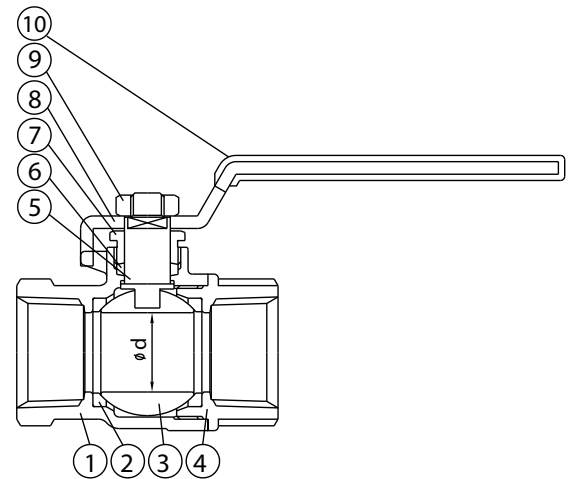

Dimensions

SIZE (inch)	L(mm)	H(m)	D(m)	ø (mm)
1/2	53	44	95	14
3/4	61	51	110	19
1	71	55	110	24
1 1/4	85	65	140	31
1 1/2	92	70	140	38
2	114	83	160	49
2 1/2	134	118	220	63

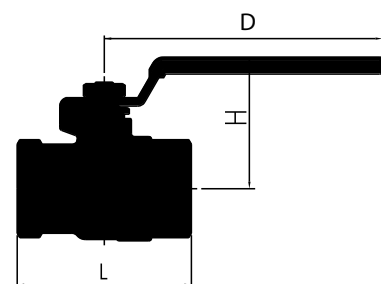

PRESSURE RATING : PN25

TEMPERATURE OPERATING RANGE : -10 to 170°C

END CONNECTION : Taper threaded to BS EN 10226-2 (ISO 7-1) formerly BS 21